

1、茗山乡茗山村古塘湾至许孔曼湾通组公路刷黑工程

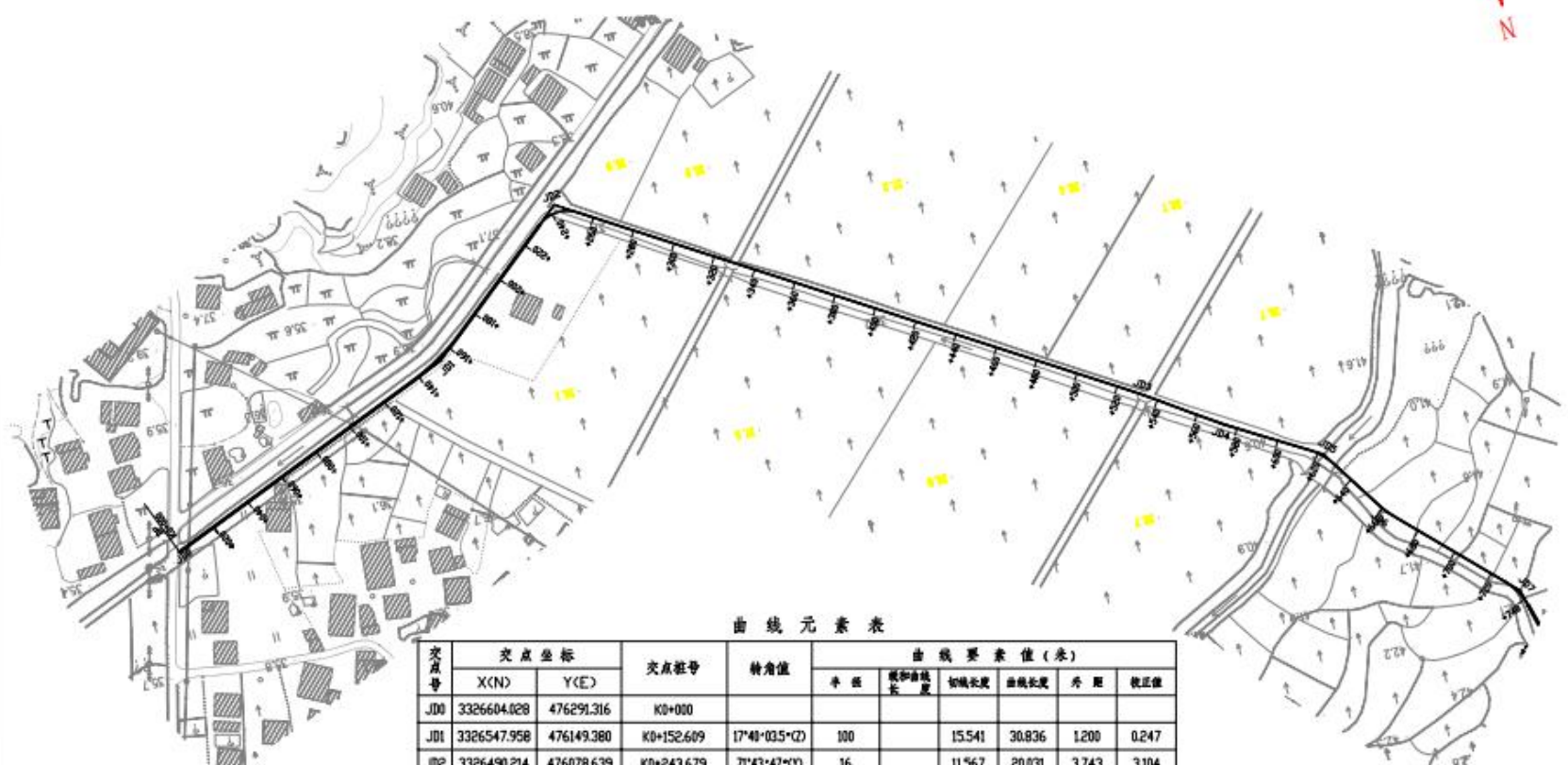

曲线元素表

交点号	交点坐标		交点桩号	转角值	曲线要素值(米)					
	X(N)	Y(E)			半圆	缓和曲线长	切线长	曲线长	外距	校正值
JD0	3326604.028	476291.316	K0+000							
JD1	3326547.958	476149.380	K0+152.609	17°48'03.5″(C)	100		15.541	30.836	1.200	0.247
JD2	3326490.214	476078.639	K0+243.679	71°43'47″(Y)	16		11.567	20.031	3.743	3.104
JD3	3326646.235	475833.793	K0+530.907	2°19'41.6″(Y)	500		10.160	20.317	0.103	0.003
JD4	3326670.540	475798.866	K0+573.455	3°39'10.4″(Z)	500		15.944	31.877	0.254	0.011
JD5	3326695.851	475757.043	K0+622.330	25°57'45.6″(Y)	30		6.916	13.594	0.787	0.237
JD6	3326729.435	475735.353	K0+662.072	12°00'44.9″(C)	60		6.313	12.579	0.331	0.046

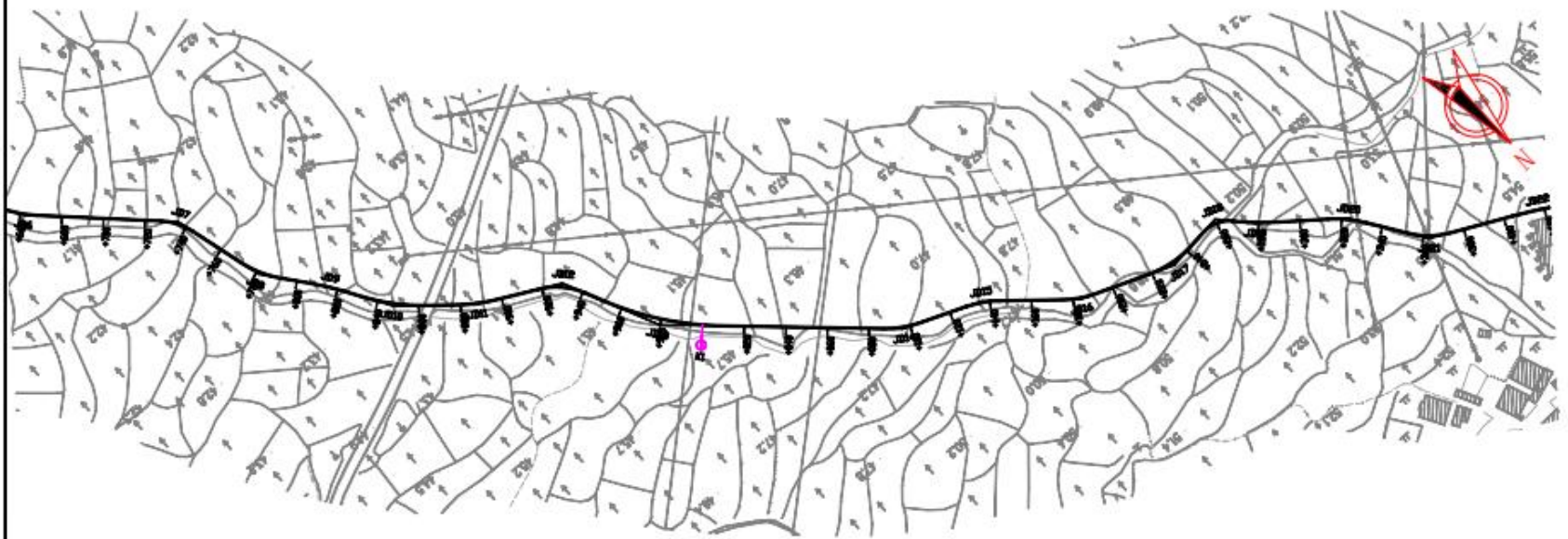

曲线元素表

交点号	交点坐标		交点桩号	转角值	曲线要素值(米)					
	X(N)	Y(E)			半径	缓和曲线长	切线长度	曲线长度	外距	校正值
JD7	3326781.714	475683.313	K0+735.791	30°19'42.4(Y)	30		8.131	15.880	1.062	0.381
JD8	3326826.584	475671.676	K0+781.763	22°51'29.4(Z)	50		10.108	19.948	1.012	0.269
JD9	3326853.322	475651.235	K0+815.151	6°35'06.1(Y)	150		8.629	17.240	0.248	0.019
JD10	3326881.247	475634.579	K0+847.647	17°20'58.6(Z)	100		15.257	30.281	1.157	0.234
JD11	3326907.960	475604.741	K0+887.462	13°16'41.1(Z)	100		11.639	23.175	0.675	0.104
JD12	3326928.412	475567.166	K0+930.138	37°18'23.1(Y)	35		11.770	22.708	1.926	0.832
JD13	3326974.569	475546.357	K0+979.937	22°11'08.8(Z)	150		29.409	58.082	2.856	0.737
JD14	3327054.985	475461.753	K1+095.925	28°09'49.8(Z)	50		8.890	17.596	0.784	0.184
JD15	3327071.154	475424.358	K1+136.482	18°10'08.9(Y)	50		7.995	15.856	0.635	0.134
JD16	3327102.319	475389.197	K1+183.332	18°59'58.1(Z)	50		8.367	16.580	0.695	0.154
JD17	3327120.754	475344.806	K1+231.246	28°17'17.1(Z)	50		12.600	24.686	1.563	0.514
JD18	3327117.784	475315.241	K1+268.445	54°44'13.2(Y)	16		8.282	15.285	2.017	1.279
JD19	3327132.358	475302.573	K1+278.476	9°54'04.8(Z)	127.311		11.028	22.001	0.477	0.055
JD20	3327168.413	475268.051	K1+322.905	17°39'24.8(Y)	60		9.319	18.490	0.719	0.148
JD21	3327194.125	475245.954	K1+363.066	29°11'52.3(Z)	40		10.418	20.384	1.335	0.453

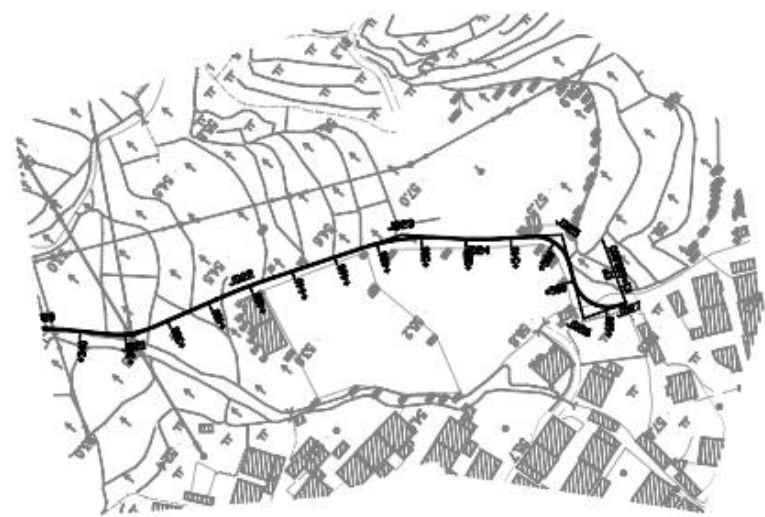

曲线元素表

交点号	交点坐标		交点桩号	转角值	曲线要素值 (米)					
	X(N)	Y(E)			半径	缓和曲线长	切线长度	曲线长度	外距	校正值
J022	3327219.511	475197.312	K1+417.481	5°11'18.5″(Y)	300		13.593	27.167	0.308	0.019
J023	3327259.683	475134.851	K1+491.727	22°29'03.6″(Y)	100		19.877	39.243	1.956	0.511
J024	3327287.239	475115.722	K1+524.760	7°40'54.9″(Z)	150		10.071	20.111	0.338	0.030
J025	3327315.452	475089.914	K1+562.966	7°05'17″(Y)	16		13.210	22.086	4.749	4.335
J026	3327346.497	475113.002	K1+597.321	95°52'01.9″(Z)	16		17.728	26.771	7.881	8.606
J027	3327356.816	475095.672	K1+608.805							

2、茗山乡茗山村许必明湾通组公路刷黑工程

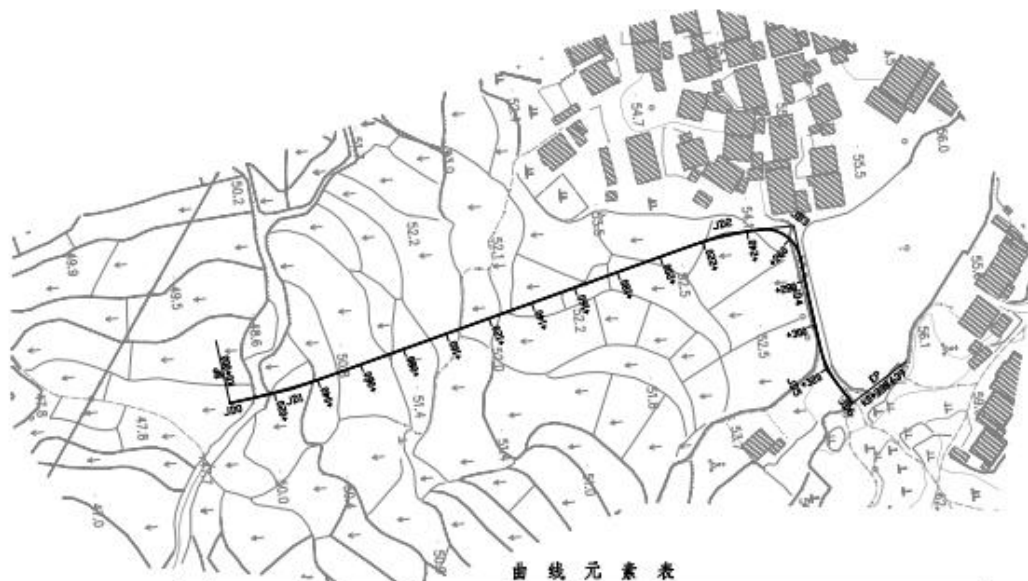

曲线元素表

交点号	交点坐标		交点桩号	转角值	曲线要素值(米)						
	X(N)	Y(E)			半径	缓和曲线长度	切线长度	曲线长度	外距	校正值	
JD0	3327100.272	475391.097	K0+000								
JD1	3327127.796	475388.500	K0+027.646	7°08'19.6"(Z)	300		18.714	37.379	0.583	0.048	
JD2	3327325.551	475344.553	K0+230.177	13°09'45.1"(Y)	138.978		16.834	31.927	0.922	0.141	
JD3	3327356.309	475344.893	K0+260.796	85°15'08.8"(Y)	16		14.726	23.807	5.745	5.646	
JD4	3327358.489	475375.194	K0+285.529	1°59'47.8"(Z)	898.238		15.652	31.301	0.136	0.003	
JD5	3327362.114	475409.056	K0+319.582	24°32'51.3"(Z)	40		8.702	17.137	0.936	0.267	
JD6	3327371.968	475425.679	K0+338.639								